



ROOM AIR CONDITIONER

INDOOR

AQT24A(B)5(6)RE/B
AQT18A(B)9(0)RE/B
AQ18A(B)9(0)RE
SH24AT(B)5
SH18ZA(B)9
AQT24A(B)5(6)RED
AQ18A(B)9(0)RE(B)D
SH24TA(B)6D
SH18ZA(B)0D
AQT24C5(6)RE/B
AQT18C9(0)RE/B
AQ24A(B)5(6)RBD
AQT18C9(0)REF

OUTDOOR

UQT24A(B)5(6)RE/B
UQT18A(B)9(0)RE/B
UQ18A(B)9(0)RE
SH24TA(B)5X
SH18ZA(B)9X
UQT24A(B)5(6)RED
UQ18A(B)9(0)RE(B)D
SH24TA(B)6DX
SH18ZA(B)0DX
UQT24C5(6)RE/B
UQT18C9(0)RE/B
UQ24A(B)5(6)RBD
UQT18C9(0)REF

SERVICE Manual

AIR CONDITIONER

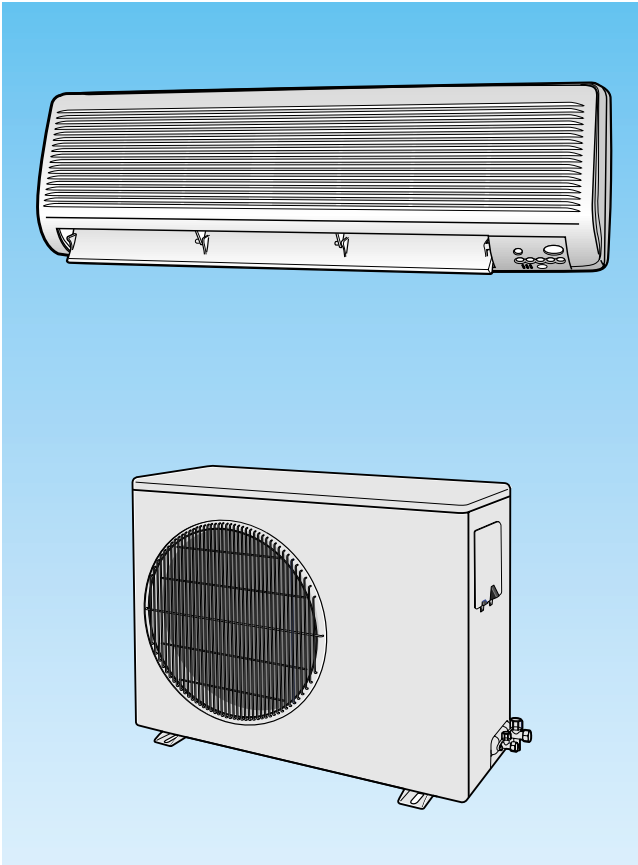

CONTENTS

1. Precautions
2. Product Specifications
3. Operating Instructions and Installation
4. Disassembly and Reassembly
5. Troubleshooting
6. Exploded Views and Parts List
7. Block Diagrams
8. PCB Diagrams
9. Wiring Diagrams
10. Schematic Diagrams

1. Precautions

1. **Warning:** Prior to repair, disconnect the power cord from the circuit breaker.
2. **Use proper parts:** Use only exact replacement parts. (Also, we recommend replacing parts rather than repairing them.)
3. **Use the proper tools:** Use the proper tools and test equipment, and know how to use them. Using defective tools or test equipment may cause problems later-intermittent contact, for example.
4. **Power Cord:** Prior to repair, check the power cord and replace it if necessary.
5. **Avoid using an extension cord, and avoid tapping into a power cord.** This practice may result in malfunction or fire.
6. **After completing repairs and reassembly, check the insulation resistance.**
Procedure: Prior to applying power, measure the resistance between the power cord and the ground terminal. The resistance must be greater than 30 megaohms.
7. **Make sure that the grounds are adequate.**
8. **Make sure that the installation conditions are satisfactory.**
Relocate the unit if necessary.
9. **Keep children away from the unit while it is being repaired.**
10. **Be sure to clean the unit and its surrounding area.**

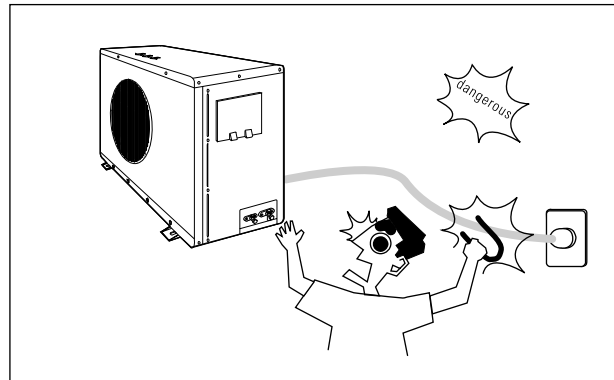

Fig. 1-1 Avoid Dangerous Contact

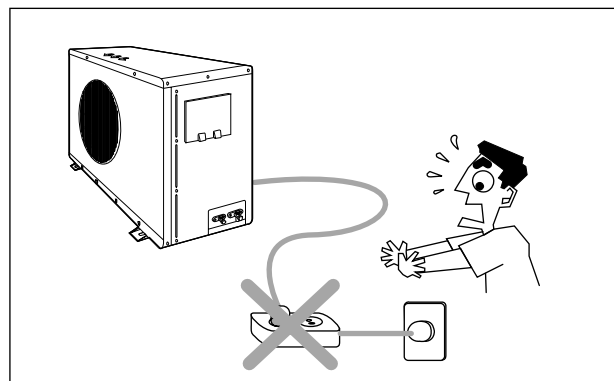

Fig. 1-2 No Tapping and No Extension Cords

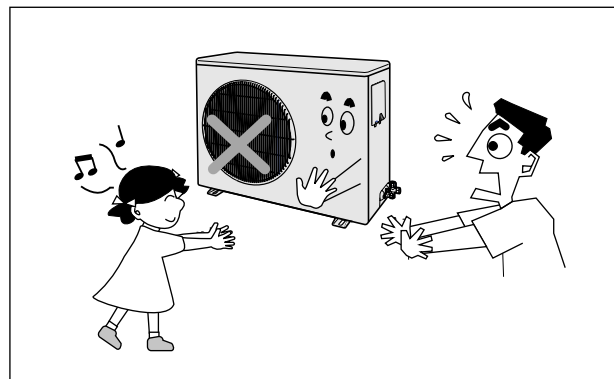

Fig. 1-3 No Kids Nearby!

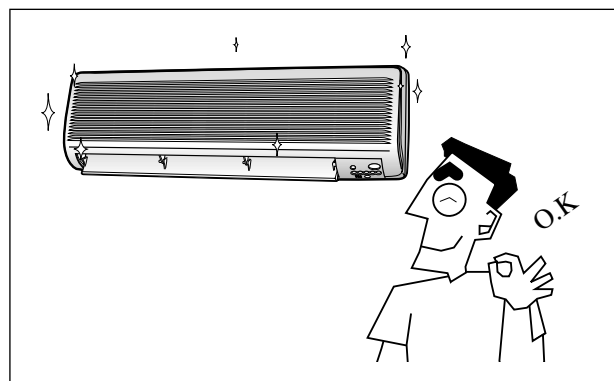

Fig. 1-4 Clean the Unit

MEMO